

**STAY**  
**FOCUSED.**



## Conference Brochure

Holiday Inn Newcastle - Jesmond  
0191 281 5511

events@hinewcastle.co.uk  
Jesmond Road, Newcastle upon Tyne, NE2 1PR

Holiday Inn Darlington A1 Scotch Corner  
01748 850 900

events@hidarlington.co.uk  
JA1/A66 Richmond near Darlington, DL10 6NR



**STAY YOU.™**  
holidayinn.com

## Holiday Inn Newcastle - Jesmond & Holiday Inn Darlington A1 Scotch Corner are now open for business.

When you're planning a business meeting, conference or training session, you need a venue which offers light, spacious rooms, full audio-visual connectivity, plenty of on-site parking and an events team geared to anticipate your every need.

At Holiday Inn Newcastle - Jesmond and Holiday Inn Darlington A1 Scotch Corner we offer all that – and more. All our conference and meeting rooms are air-conditioned and enjoy state-of-the-art facilities while the chefs at our on-site Fratello's restaurants can provide everything from pastries to formal, seated lunches for delegates. Both hotels are easily accessed and each boasts a dedicated events manager to ensure your corporate event runs smoothly.



So, contact Holiday Inn Newcastle - Jesmond and Holiday Inn Darlington A1 Scotch Corner for your next conference or event – it's a pleasure doing business with you.

- Day delegate rack rate £50 per person
- 24 hour residential rack rate £175 per person
- Meeting rooms available in a variety of sizes
- Conference facilities for up to 200 delegates
- Parking available at both locations

**HOLIDAY INN NEWCASTLE -JESMOND AND  
HOLIDAY INN DARLINGTON A1 SCOTCH CORNER**  
– A PLACE FOR EVERYTHING.

Holiday Inn Newcastle - Jesmond  
**0191 281 5511**  
or [events@hnewcastle.co.uk](mailto:events@hnewcastle.co.uk)

Holiday Inn Darlington A1 Scotch Corner  
**01748 850 900**  
or [events@hidarlington.co.uk](mailto:events@hidarlington.co.uk)

# Day Delegate Packages

## Day Delegate Packages

Minimum numbers of 20 delegates apply



### Rack Day Delegate

£50 per person, inc VAT

#### Includes:

- Room hire
- Bottles of mineral water
- Confectionery
- Standard AV equipment
- Stationery box
- Place cards
- 4 servings of tea & coffee with biscuits
- Fruit bowl for the room
- Simply Uplifting healthy lunch options

## 24 Hour Residential Packages

# 24 Hour Residential Packages

Minimum numbers of 20 delegates apply



### Rack 24 Hour Residential Package

£175 per person, inc VAT

#### Includes:

- Room hire
- Bottles of mineral water
- Confectionery
- Standard AV equipment
- Stationery box
- Place cards
- 4 servings of tea & coffee with biscuits
- Fruit bowl for the room
- Simply Uplifting healthy lunch options
- Dinner
- Accommodation with breakfast

## Day Delegate Packages

### Enhance Your Packages

---

Bacon rolls or egg rolls on arrival  
£4.50 per person

Danish pastries  
£2.50 each

Selection of cakes for  
afternoon tea  
£5.00 per person



### Refreshment Charges

---



Tea, coffee & biscuits  
£2.50 per person

Fresh orange juice  
£9.00 per 2 pint jug

Bottles of mineral water  
£3.95 per bottle

Cordial  
£3.95 per 2 pint jug

## Room Capacity Chart & Floor Plans

Room	Theatre	Cabaret	Boardroom	Classroom	Dinner	Reception	Room Hire
Imperial Suite 1	140	66	46	74	100	120	£500
Imperial Suite 2	120	54	38	64	120	120	£500
Imperial Suite (Whole)	320	132	80	160	220	300	£1000
Tyne Room	28	12	8	14	20	25	£200
Millennium Room	16	6	6	8	10	15	£200
Jesmond Room	28	12	8	14	20	25	£200
Rothbury Suite	150	60	44	60	120	140	£500
Belford Room	40	24	24	29	36	40	£200

# Scotch Corner Room Capacity

## Room Capacity Chart & Floor Plans

Room	Boardroom	Theatre	U-Shape	Classroom	Cabaret	Half day	Full day
Richmond 1	45	120	40	60	60	£350	£500
Richmond 2	20	50	15	25	24	£225	£300
Richmond 3	25	60	20	30	40	£275	£350
Richmond 4	20	50	15	25	24	£225	£300
Richmond Suite	60	350	50	100	150	N/A	£1250
Bedale	15	20	10	12	N/A	£175	£225
Barton	10	20	N/A	8	N/A	£150	£200
Middleton	6	N/A	N/A	N/A	N/A	£125	£175

# Jesmond Floor Plans

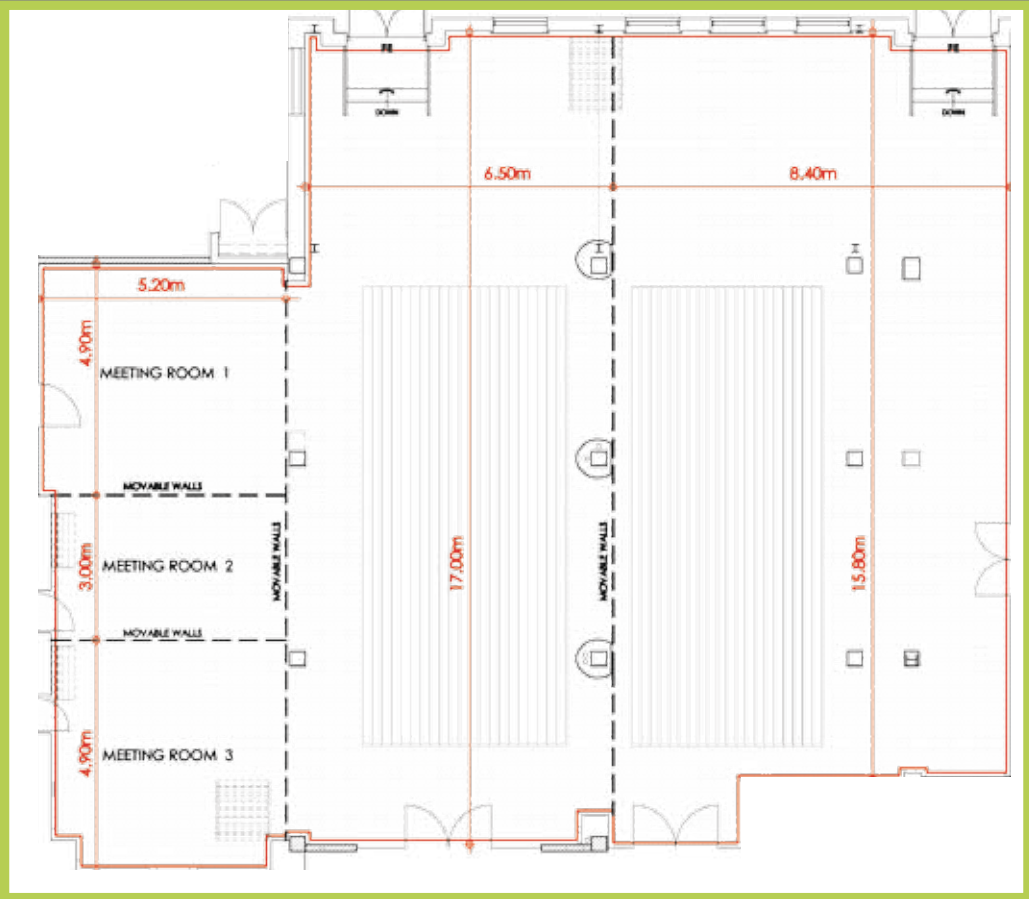
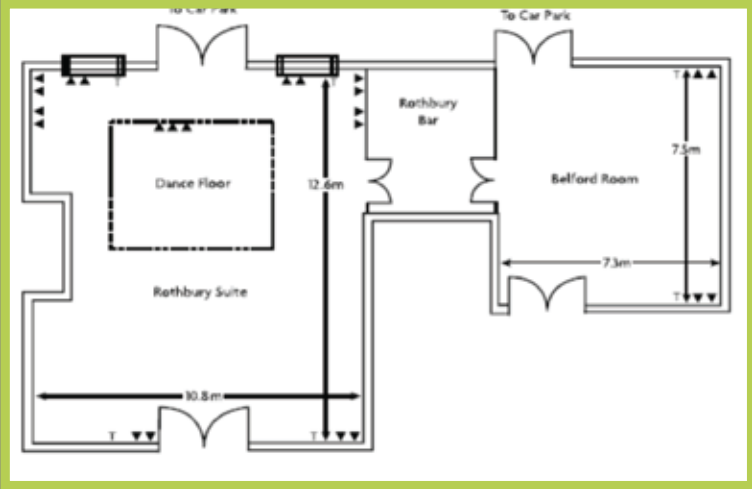



# Scotch Corner Floor Plans

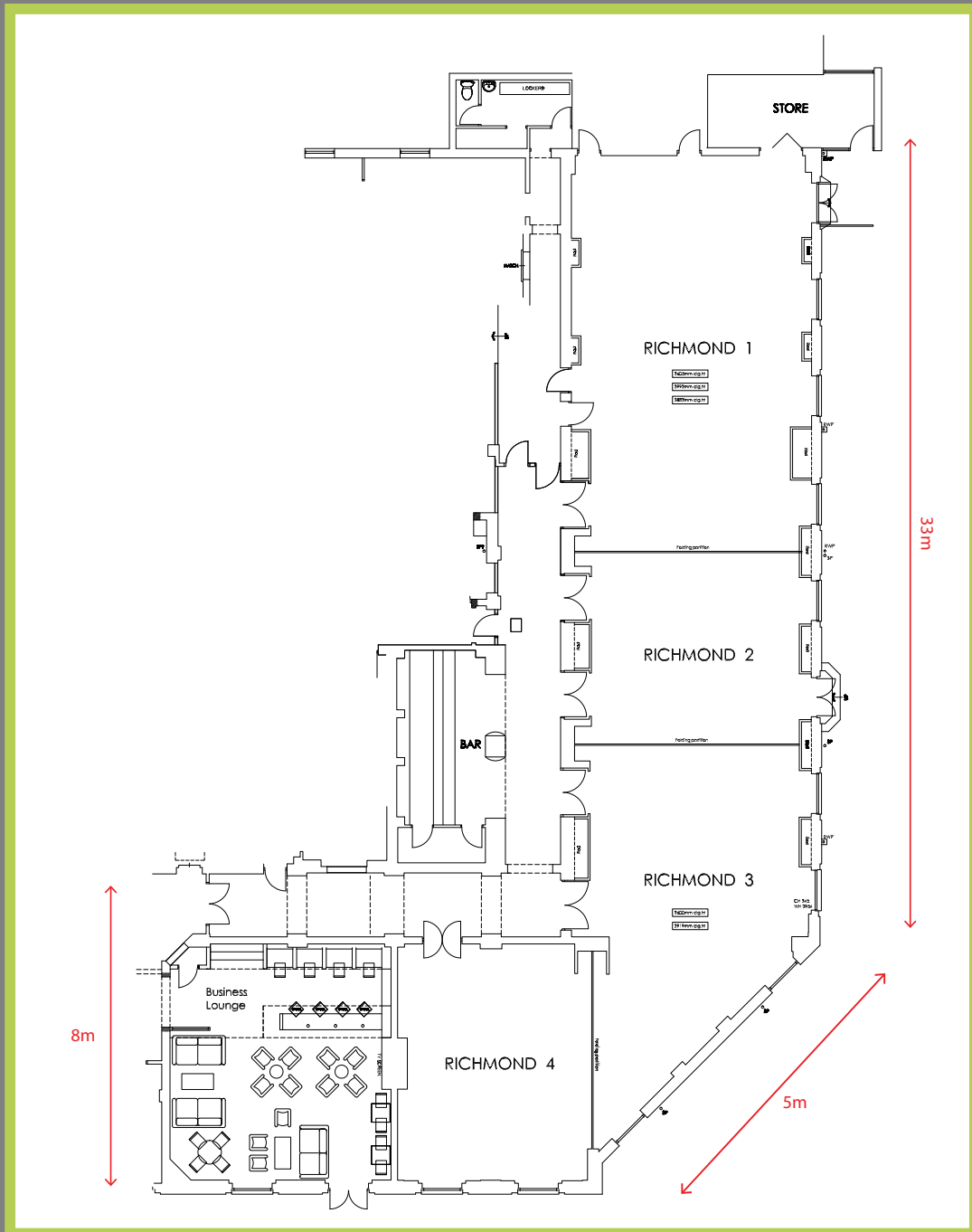

Holiday Inn Newcastle - Jesmond

**0191 281 5511**

[events@hincastle.co.uk](mailto:events@hincastle.co.uk)

Jesmond Road, Newcastle upon Tyne, NE2 1PR

Holiday Inn Darlington A1 Scotch Corner

**01748 850 900**

[events@hidarlington.co.uk](mailto:events@hidarlington.co.uk)

JA1/A66 Richmond near Darlington, DL10 6NR



**STAY YOU.™**

[holidayinn.com](http://holidayinn.com)